



DAVINCI TECHNICAL DATA GUIDE

# SWING CHECK VALVE

## 90° METAL SEAT PN10-16

Ref. 116A-UF / PN 10-16



### Application

Water and sewage hydraulic installations.  
Heating installations.

### Approvals/Standards

Face to face distance DIN3202- F1/F7  
Mounting flanges EN 1092-2 PN10/16  
Pressure test EN 1266-1 Rate C  
Pressure test: Body 1.5 x PN, seat 1.1 x PN.

### Certifications

CE

### Range

DN40-1000, PN10-16



## GENERAL CHARACTERISTICS

Sizes DN40 to DN1000.  
 Working pressure PN10/16.  
 Full bore.  
 Lever and counterweight available under request.  
 Brass seat, other materials available under request.

## WORKING CONDITIONS

Pressure ratings: 1.0 Mpa, 1.6 Mpa.  
 Working temperature: -10°C + 120°C  
 Maximum fluid speed: 3.2 m/s.

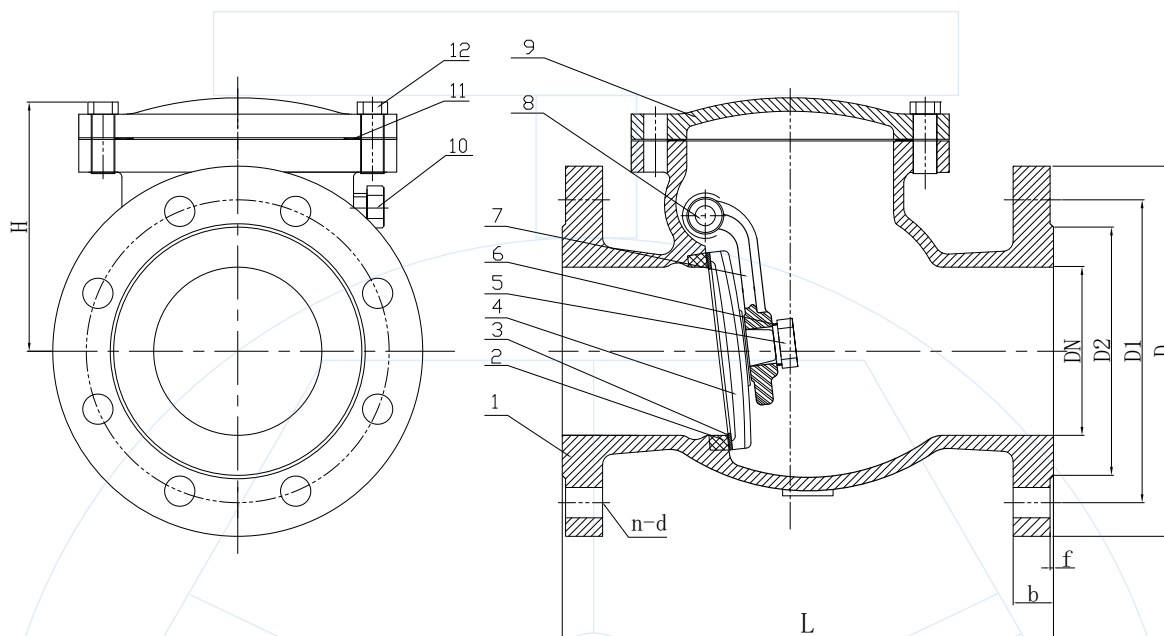

Components may be replaced with materials of equivalent or superior grade without prior notice, in accordance with our continuous improvement policy.

N°	ITEM	MATERIAL	DN	L	H	PN10				PN16				b	f
						D	D1	D2	Z-Ød	D	D1	D2	Z-Ød		
1	Body	GJS500-7													
2	Body seat	Brass	40	180	120	150	110	84	4-19	150	110	84	4-19	18	3
3	Disc seat	Brass	50	200	137	165	125	99	4-19	165	125	99	4-19	18	3
4	Disc	GJS500-7	65	240	147	185	145	118	4-19	185	145	118	4-19	18	3
5	Cap	A2-70	80	260	159	200	160	132	8-19	200	160	132	8-19	20	3
6	Washer	A2-70	100	300	180	220	180	156	8-19	220	180	156	8-19	20	3
7	Plug	GJS500-7	125	350	203	250	210	184	8-19	250	210	184	8-19	22	3
8	Plug axle	AISI420	150	400	223	285	240	211	8-23	285	240	211	8-23	22	3
9	Bonnet	GJS500-7	200	500	258	340	295	266	8-23	340	295	266	12-23	24	3
10	Bolt	AISI5140	250	600	290	395	350	319	12-23	405	355	319	12-28	26	3
11	Gasket	Graphite	300	700	325	445	400	370	12-23	460	410	370	12-28	28	4
12	Bolt	AISI5140													
	RAL 5015 Painting	Epoxy 250 µm													

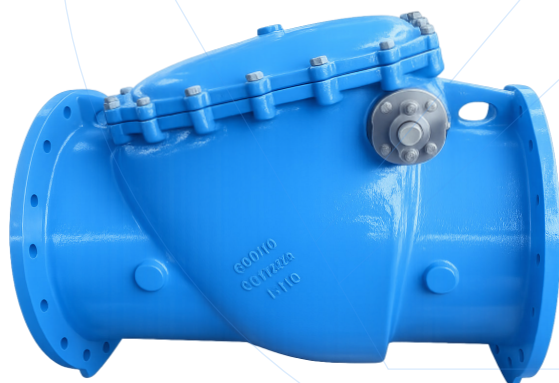
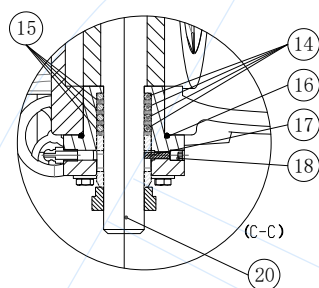
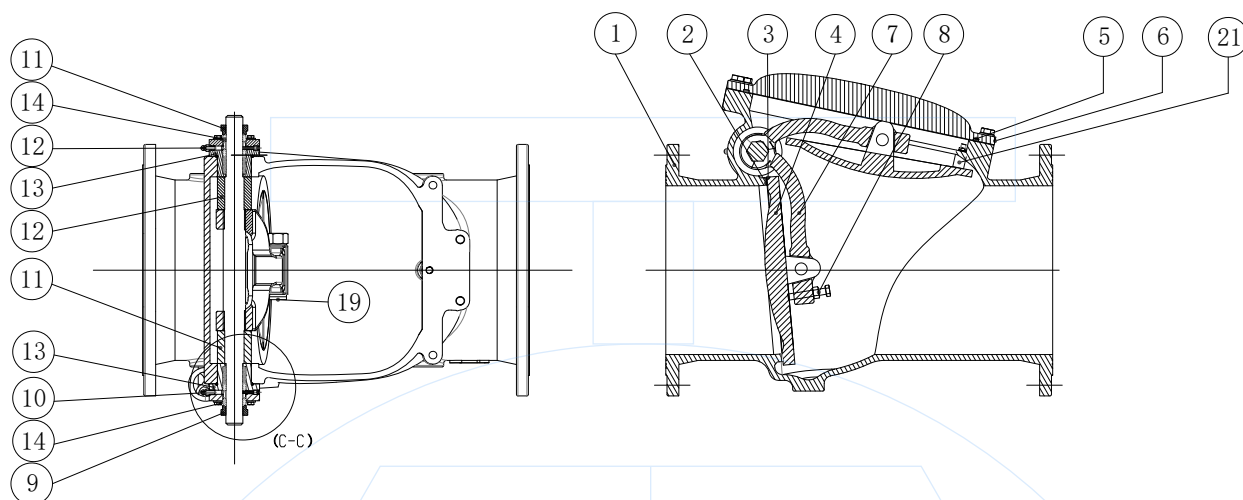

N°	ITEM	MATERIAL
1	Body	GJS500-7
2	Valve seat	Bronze
3	Seal ring	Bronze
4	Disc	GJS500-7
5	Seal gasket	EPDM
6	Bonnet	GJS500-7
7	Rocker arm	GJS500-7
8	Bolt+gasket	A2-70
9	Mould weight	AISI420
10	Glib	Brass
11	Stop collar	Nylon
12	Shaft sleeve	Bronze
13	Shaft seat	AISI420
14	O-ring	EPDM
15	Packing	PTFE
16	O-ring	EPDM
17	Pin	AISI304
18	Plug screw	Carbon steel
19	Pin	AISI420
20	Rotation axis	AISI420
21	Shock absorber	Polyurethane
	Bolts, nuts & washers	A2-70
	RAL 5015 Painting	Epoxy 250 µm

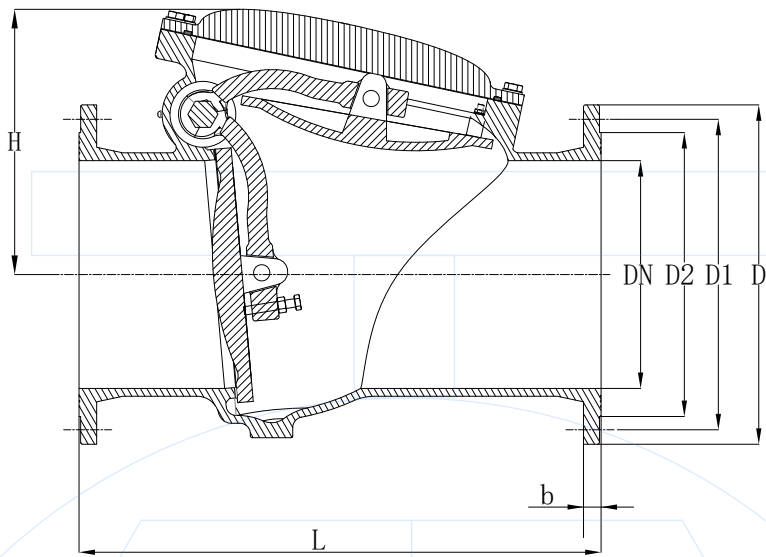

DN	L	H	b	PN10				PN16				Weight (kg)
				D	D1	D2	Z-Ød	D	D1	D2	Z-Ød	
350	800	407	26.5	520	460	429	16-23	520	470	429	16-28	224
400	900	459	28	580	515	480	16-28	580	525	480	16-31	340
450	1000	531	30	640	565	530	20-28	640	585	548	20-31	600
500	1100	531	32	715	620	582	20-28	715	650	609	20-34	700
600	1300	590	36	840	725	682	20-31	840	770	720	20-37	802
700	1500	730	40	910	840	794	24-31	910	840	794	24-37	1461
800	1700	795	43	1025	950	901	24-34	1025	950	901	24-40	2150
900	1900	870	47	1125	1050	1001	28-34	1125	1050	1001	28-40	2900
1000	2100	960	50	1230	1160	1112	28-37	1255	1170	1112	28-43	3800

### OPTIONS

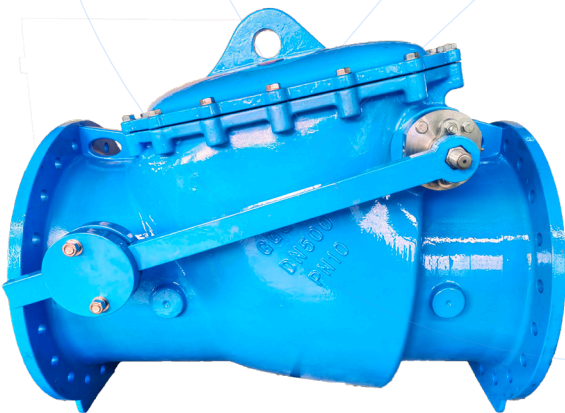

Valve with lever and counterweight.

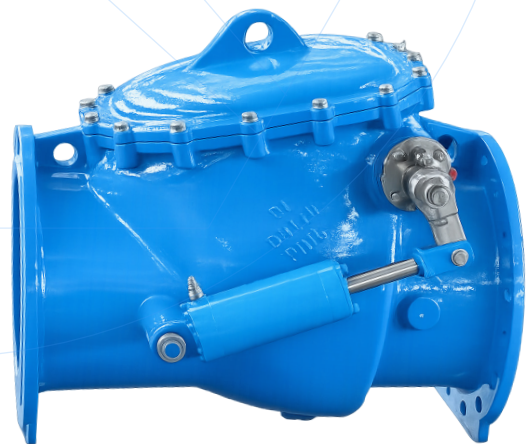

Valve with hydraulic damper



CONTACT US

# DAVINCI VALVES ORDER REQUEST



## Head Office CHENGDU

Room 3208 Unit 1 Building 1,  
No. 6 Zhiquan Section, Dongda Street  
Jinjiang District, Chengdu, Sichuan  
CHINA

+86 17340168233 +86 19302892712  
valves@davincivalves.com

Europe Office MADRID  
SPAIN

zuzana@davincivalves.com

## WEBSITE

davincivalves.com

**YOUR QUALITY WATER PROJECTS PARTNER**  
For professionals who look for more.